

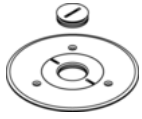

# ELLIOTT ELECTRIC SUPPLY

We Deliver...Lower Cost, Quality Products, & Personal Service

1612 E. Booth Road  
72143-0000, AR Searcy  
Phone: 501-368-0309  
Fax: 501-368-0619



## 896CK1 Brass CPT Comb Plate 1 PLG

Wiremold/Legrand

Catalog Number	896CK1
Manufacturer	Wiremold/Legrand
Description	<P>Brass Cover Plate With 1" (25MM) Threaded Opening For Carpet. Note: For Carpet or Tile Installations. All Cover Plates Are Furnished With Gasket and Three Screws. The 895P Polycarbonate Series Cover Plates Must Be Field Modified For Dual Service.</P>
Weight per unit	1.1 (lbs/each)
Product Category	Floor Boxes & Accessories

### Features

media	Yes
-------	-----

### Material, Color, and Finish

Cover Material	Brass
----------------	-------

### Descriptions

Construction	ASSEMBLED
Description	BRASS CPT COMB PLATE 1 PLG
extra long description	WLK 896CK-1 BRASS CPT COMB PLT 1 PL
Features	<p>Brass cover plate with 1" (25mm) threaded opening for carpet. NOTE: For carpet or tile installations. All cover plates are furnished with gasket and three screws. The 895P Polycarbonate Series Cover Plates must be field modified for dual service.</p>
Long Description	<p>Brass cover plate with 1" (25mm) threaded opening for carpet. NOTE: For carpet or tile installations. All cover plates are furnished with gasket and three screws. The 895P Polycarbonate Series Cover Plates must be field modified for dual service.</p>
Product Type	Brass CPT Comb PLT 1 PLG
Special Features	Snap down ring assembly for steel floor boxes. Fully adjustable box. TopGuard protection.

### Manufacturer Information

Brand	WIREMOLD
GTIN	00786564276401
Manufacturers Part Number	896CK-1
UPC	786564276401

### Taxonomies, Classifications, and Categories

Category Description	FLOOR BOXES
Type	COVER



# ELLIOTT ELECTRIC SUPPLY

We Deliver...Lower Cost, Quality Products, & Personal Service

1612 E. Booth Road  
72143-0000, AR Searcy  
Phone: 501-368-0309  
Fax: 501-368-0619

## Packaging

Carton	1
Weight Per each	1.144

## Uses, Certifications, and Standards

standard	ROHS, CULUS, cULus Listed Metallic Outlet Boxes: File E2961 Guide QCIT Meets Article 314.27(C) of NEC.
----------	---